

SA-1 (CLASS-VIII)

8/2016

SUBJECT : ENGLISH

Time : 3 hrs

MM : 80

General Instructions :

- i) Read the questions carefully.
- ii) Number the answers as given in the question paper.
- iii) Write in a neat and clear handwriting.
- iv) Write the answers in complete sentences.

SECTION-A (READING)

Q1. Read the passage given below and answer the questions that follow : (7)

The 137 km long coastline of Goa on the golden Konkan coast of the Western Ghats is along the Arabian Sea. This small former Portuguese enclave is one of India's most popular tourist spots. The name Goa is derived from the Konkani word 'Goyan', which means 'a patch of tall grass'.

Once a great Hindu stronghold, Goa was a part of the grand Mauryan Empire, around the 3rd century B.C. Goa soon became the subject of dispute between the Dutch, the English, the French and the Portuguese, all vying for its possession. Ultimately, in 1510, the Portuguese conquered Goa, with Alfonso de Albuquerque leading the invasion.

Goa is geographically divided into North and South Goa. Panaji, situated on the south bank of river Mandovi is the capital of Goa state. Ten kms from Panaji is the former Portuguese capital of old Goa, where it is worth spending a day to see the old churches and remains of the former colony.

The beaches of North Goa are Miramar and Dona Paula, Calangute, Baga, Anjuna and Vagator.

Goa is also known for its varied cuisine. Some of the specialities of Goan cuisine include vindaloo, sorpotel and xacuti. Besides this, Goa is also well-known for prawns and lobsters which come in various sizes, crabs, cashewnuts and feni.

October to March is considered the best season to holiday in Goa. If you can tolerate the soaring temperatures, April and May find Goa in a quiet lethargic mood with the sea still calm enough to swim in. More recently, Goa is being promoted as a monsoon destination.

- (a) What is the location of Goa? (1)
- (b) Where is the name Goa derived from? (1)
- (c) Describe the cuisine of Goa. (2)

(C-1)

(d) Name the capital of the Goa state. Where is it situated? (1)

(e) Complete the following sentences - (1)

In 1510, the Portuguese _____.

(f) Find the words from the passage which mean the same as given below: ($2 \times \frac{1}{2} = 1$)

(i) to take control of a place through force

(ii) inactive, lazy and dull

Q2. Read the poem given below and answer the questions that follow: (6)

I had gone a begging from door to door in the village path,
When thy golden chariot appeared in the distance
Like a gorgeous dream and I wondered
Who was this king of all kings!

My hopes rose high and me thought
my evil days were at an end,
and I stood waiting for alms to be given unasked
and for wealth scattered on all sides in the dust.

The chariot stopped where I stood.
Thy glance fell on me
and thou camest down with a smile
I felt that the luck of my life had come at last.
Then of a sudden thou didst hold out thy right hand
and say "what hast thou to give to me?"

Ah, what a highly jest was it
I was confused and stood undecided,
and then from my wallet I slowly took out
the least little grain of corn and gave it to thee.

But how great my surprise when at the day's end
I emptied my bag on the floor to find
a least little grain of gold among the poor heap.
I bitterly wept and wished
that I had had the heart to give thee my all.

(a) Why did the speaker go from door to door? (1)

(b) Why did the speaker's hopes rise on seeing the golden chariot? (1)

(c) What did the speaker take out from his wallet? (1)

(d) What did the speaker wish in the end? (1)

(e) What did the speaker find when he emptied his bag on the floor? (1)

(f) Find words from the poem which mean the same as the following : (2x½=1)

(i) attractive

(ii) cried

SECTION-B (WRITING)

Q3. Draw an attractive poster on spreading awareness among the people on dengue prevention. (4)

Q4. Teacher's Day was organized by your school yesterday. Your best friend could not attend it due to his/her illness. Write him/her an e-mail describing the fun you had and how much you and others missed him/her. (4)

Q5. You are Amrit/Amrita. Your younger sister is staying in a hostel. Write a letter guiding her about healthy eating habits and telling her the importance of following a routine of meals. (6)

SECTION-C (GRAMMAR)

Q6. Fill in the blanks with suitable relative pronouns : (4x½=2)

(a) All the workers _____ work in this factory get good wages.

(b) The boy _____ is wearing a red shirt is my best friend.

(c) _____ bag is lying under the table?

(d) The car _____ is parked near my house is very expensive.

Q7. Fill in the blanks with suitable determiners : (4x½=2)

(a) Give me _____ water to wash the utensils.

(b) Sonam ate _____ biscuits and left for her interview.

(c) _____ students participated in the camel colour contest.

(d) You can come on _____ working day.

Q8. Fill in the blanks with appropriate form of adverbs formed from the adjectives given in the brackets : (4x½=2)

(a) The teacher spoke very _____. (polite)

(b) Siya entered the classroom _____. (happy)

(c) Some people are god gifted. They draw _____. (beautiful)

(d) The beggar was _____ deaf. (entire)

Q9. Complete these sentences by adding the correct question tags : (2x1=2)

(a) We will arrange all the books in correct order, _____?

(b) She is not coming to the party, _____?

Q10. Rearrange the given words/phrases to form meaningful sentences : (2x1=2)

(a) cards / for / Shreya / Diwali / and candles / making / is

(b) exciting / reading / I / am / book / these days / an

Q11. Replace the underlined words with adverbs :

(a) My sister joined the academy with full agreement.

(b) All the dancers at Kingdom of Dreams danced with a lot of enthusiasm.

Q12. Fill in the blanks with collective nouns :

(a) Supriya forgot to buy the _____ of grapes from the market.

(b) We attended a concert and appreciated the _____ of singers who performed brilliantly.

Q13. Change the voice of the given sentences and rewrite them :

(a) My mother prepared delicious dessert for the guests. (Passive voice)

(b) The fruit has been eaten by Riya. (Active voice)

(c) The children were decorating the activity hall. (Passive voice)

Q14. Fill in the blanks with the correct forms of verbs given in the brackets :

Yesterday, it was (a) _____ (rain) heavily. When I (b) _____ (return) from school I was fully (c) _____ (drench) in water. Despite my mother's warning, I

(d) _____ (eat) an ice-cream and (e) _____ (get) fever. My mother (f) _____ (scold) me for my stupidity.

SECTION-D (LITERATURE)

Q15. Read the extracts given below and answer the questions that follow :

(A) 'Pray what is the reason I see none at all -

That I always must go when Suke chooses to call?

Whatever I'm doing - tis certainly hard -

I'm forced to leave off, to be milked in the yard?

(a) Who does the word 'I' refer to in the above lines?

(b) What is the mood of the speaker while speaking the above lines?

(c) Is the speaker enjoying her stay with the Suke? Why/why not?

(B) "Congratulations, Mrs. Sharma, I am afraid we don't have any gold medal left for you but"

(a) Who is the speaker of the above lines?

(b) Why did the speaker congratulate Mrs. Sharma?

(c) Was the speaker right in doing so? Why/why not?

Q16. Answer the following questions in 30-40 words each : (3x2=6) 016

(a) What did Mukul Sharma speak in his oath? Whom did he honour at the end?

(b) Describe the narrator's meeting with the district officer with reference to the chapter 'The Undeserved Reward'. 80

(c) Before opening the vault, what strange request did Jimmy make and why?

Q17. Answer the following questions in 30-40 words each : (2x2=4)

(a) In the poem, 'The Cow and the Ass' the cow changed her opinion. What led her to do so?

(b) Who was Lochinvar? Why did he go to Netherby Hall?

Q18. Answer the following question in 70-80 words : (1x4=4) (7)

The poet in the poem, 'The Cold Within' portrays a sad picture but comes up with an excellent message. Explain the message conveyed through the poem. iats
ia's
an'

OR

The poem, 'Lochinvar' took a sudden twist towards the end when Ellen was going to get married. Elucidate. irc.
the
on.

Q19. Answer the following question in 80-100 words : (1x5=5) que

'Despite knowing everything about Jimmy's present and past life, Ben made a strange decision and the story ended on a positive note'. Explain the statement with reference to the chapter 'A Retrieved Reformation'. the
the
old

OR

In the story, 'The Attic' Aditya was regretful of his past action. What did he do to make up? Write a diary entry describing Aditya's feelings. ana

Q20. Answer the following question in 30-40 words : (1x3=3)

Describe what Pip found when he returned from the town. Why did he suspect Orlick? sine
wns

Q21. Answer the following question in 80-100 words : (1x5=5)

Describe Ms. Havisham's character and also describe the house in which she was living. rate
the
oon

OR

Who met Pip in the churchyard and what did he ask for? Why didn't Pip enjoy the Christmas Party? (1)
(1)
(2)

विषय : हिन्दी

समय : 3 घंटे

पूर्णांक : 80

(खण्ड - क)

प्र1. निम्नलिखित गद्यांश को पढ़कर नीचे लिखे प्रश्नों के उत्तर दीजिए :-

बचपन में बालक अबोध होता है। उसे अच्छे-बुरे की पहचान नहीं होती। उसका मन शीशे की तरह स्वच्छ होता है। वह दूसरों की संगति में रहकर उनके कार्यों का अनुकरण करता है। यदि वह अच्छी संगति में रहता है तो उस पर अच्छे संस्कार पड़ते हैं और यदि उसकी संगति बुरी है तो उसकी आदतें भी बुरी हो जाती हैं। हमें यह प्रयास करना चाहिए कि हम निरंतर अच्छे, चरित्रवान एवं कर्तव्यनिष्ठ व्यक्तियों की संगति में रहें। यह ध्यान रखना आवश्यक है कि कुसंगति का प्रभाव अधिक तीव्रता के साथ होता है। झूठे और बुरे आचरण वाले व्यक्तियों के साथ रहने से जीवन कष्टों से भर जाता है। मित्र, सगे-संबंधी उनसे दूर रहने लगते हैं। कोई उन पर विश्वास नहीं करता है। सत्संगति से दुष्ट स्वभाव का व्यक्ति भी सुधर जाता है। महात्मा बुद्ध की संगति में आकर अंगुलिमाल ने नर हत्या को त्याग दिया था। इसी प्रकार डाकू बाल्मीकि भी सत्संगति के कारण महान कवि बने और 'रामायण' जैसे महान ग्रंथ की रचना कर सके।

- (क) बचपन में बालक का मन कैसा होता है? (1)
- (ख) हमें कैसे व्यक्तियों की संगति करनी चाहिए? (1)
- (ग) बुरी संगति में रहने से जीवन पर क्या प्रभाव पड़ता है? (1)
- (घ) सत्संगति से किन-किन के जीवन में बदलाव आया? (1)
- (ङ) 'तीव्रता' शब्द से मूल शब्द व प्रत्यय अलग करके लिखिए। (1)

प्र2. निम्नलिखित काव्यांश को पढ़कर दिए गए प्रश्नों के उत्तर दीजिए :-

इतनी ऊँची इसकी चोटी कि सारी धरती का ताज यही।
पर्वत-पहाड़ से भरी धरा पर केवल पर्वतराज यही।
जैसा यह अटल, अडिग-अविचल, वैसे ही हैं भारतवासी
हे अमर हिमालय धरती पर, तो भारतवासी अविनाशी।
कोई क्या हमको ललकारे, हम कभी न हिंसा से हारे,
गंगा का जल जो भी पी ले, वह दुख में भी मुसकाता है,
गिरिराज हिमालय से भारत का कुछ ऐसा ही नाता है।

(1)

टकराते हैं इससे बादल, तो खुद पानी हो जाते हैं।
तूफान चले आते हैं, तो ठोकरें खाकर सों जाते हैं।
जब-जब जनता को कठिनाई हुई, तब-तब निकले लाखों गांधी।
इसकी छाया में तूफान, चिरागों से शरमाता है,
गिरिराज हिमालय से भारत का कुछ ऐसा ही नाता है।

- (क) कवि के अनुसार धरती का ताज कौन है? (1)
(ख) हिमालय और भारतवासियों के कौन से गुण समान हैं? (1)
(ग) 'गंगा का जल मुसकाता है' - पंक्ति का क्या अर्थ है? (1)
(घ) पुनरुक्ति प्रकाश अलंकार के दो उदाहरण छाँटकर लिखिए। (1)
(ङ) काव्यांश के लिए उचित शीर्षक दीजिए। (1)

(खण्ड - ख)

- प्र3. (क) 'त्र' संयुक्त व्यंजन से दो शब्द बनाइए। (1)
(ख) भाववाचक संज्ञा बनाइए :- निर्भर, धकना (1)
(ग) लिंग बदलिए :- महोदया, चलवान (1)
(घ) निम्नलिखित वाक्य में रेखांकित शब्द का वचन बदलकर वाक्य पुनः लिखिए:- (1)
लेखिका ने रोचक कहानी लिखी है।
(ङ) निम्नलिखित वाक्यों में रेखांकित पदों के कारक भेद बताइए :- (1)
(i) मैं घर में नहीं हूँ।
(ii) यह रमेश के भाई की पुस्तक है।
- प्र4. (क) दिए गए शब्द से उपसर्ग और प्रत्यय अलग कीजिए :- (1)
अधार्मिक
(ख) निम्नलिखित वाक्यों में उचित सर्वनाम द्वारा रिक्त स्थान भरिए :- (1)
(i) _____ कहाँ जाएँगे?
(ii) बच्चा _____ कार्य करता है।
(ग) निम्नलिखित वाक्यों में विशेषण रेखांकित कर भेद बताइए :- (2)
(i) रमा मेरे लिए विदेशी यड़ी लाई है।
(ii) वह चित्र मधुर ने बनाया है।
- प्र5. (क) दो-दो पर्यायवाची शब्द लिखिए :- चतुर, धन (2)
(ख) विलोम शब्द लिखिए :- चेतन, प्रकाश (1)

(ग) दिए गए शब्द के दो भिन्न अर्थ लिखिए :- उपचार (1)

(ख) निम्नलिखित मुहावरों का वाक्यों में प्रयोग कीजिए :- (2)

आग बबूला होना, ईट से ईट बजाना

(खण्ड - ग)

प्र6. निम्नलिखित काव्यांश को पढ़कर नीचे दिए गए प्रश्नों के उत्तर लिखिए :

हम भिखमंगों की दुनिया में
स्वच्छंद लुटाकर प्यार चले
हम एक निसानी-सी उर पर,
ले असफलता का भार चले।
अब अपना और पराया क्या?
आबाद रहें रुकने वाले!
हम स्वयं बँधे थे और स्वयं
हम अपने बंधन तोड़ चले।

(क) काव्यांश में 'हम' शब्द का प्रयोग किसके लिए किया है और वह अपने हृदय पर कौन-सा बोझ लेकर चलते हैं? (2)

(ख) कवि किन लोगों के लिए, क्या प्रार्थना करते हैं? (2)

(ग) कविता की भाषा एवं कवि का नाम बताइए। (1)

प्र7. (क) 'मनुवाँ तो दहुँ दिसि फिरै, यह तो सुगिरन नाहिँ' के द्वारा कबीर क्या कहना चाहते हैं? (2)

(ख) कविता 'सुदामाचरित' की भाषागत विशेषताएँ बताइए। (2)

प्र8. निम्नलिखित गद्यांश को पढ़कर नीचे लिखे प्रश्नों के उत्तर दीजिए :

मैं बहुधा हर गर्मी की छुट्टी में अपने मामा के यहाँ चला जाता और एक-आध महीने वहाँ रहकर स्कूल खुलने के समय तक वापस आ जाता। परंतु दो-तीन बार ही मैं अपने मामा के यहाँ गया होऊँगा तभी मेरे पिता की एक दूर के शहर में बदली हो गई और एक लंबी अवधि तक मैं अपने मामा के गाँव न जा सका। तब लगभग आठ-दस वर्षों के बाद जब मैं वहाँ गया तो इतना बड़ा हो चुका था कि लाख की गोलियों में मेरी रुचि नहीं रह गई थी। अतः गाँव में होते हुए भी कई दिनों तक मुझे बदलू का ध्यान न आया।

(क) लेखक लंबे समय तक अपने मामा के गाँव क्यों नहीं गए? (2)

(ख) लेखक की लाख की गोलियों में रुचि कम क्यों हो गई थी? (1)

प्र9. निम्नलिखित प्रश्नों के उत्तर विस्तार से दीजिए : (3x2=6)

(क) लेखक यात्रा के दौरान रास्ते में आने वाले हर पेड़ को अपना मन क्यों समझ रहे थे? पाठ 'बस की यात्रा' के आधार पर बताइए।

(ख) पाठ 'क्या निराश हुआ जाए' के आधार पर बताइए कि लेखक बुरी बातों की बजाय अच्छी बातों को देखने की प्रेरणा क्यों देते हैं?

प्र10. (क) निम्नलिखित शब्दों के अर्थ लिखिए : (2)

फवना, गोता, निरीह, उजागर

(ख) निम्नलिखित शब्दों का वाक्य में प्रयोग कीजिए : (2)

संकोच, मूल्य

प्र11. पाठ 'बस की यात्रा' में लेखक ने बस की तुलना किससे और क्यों की? आपने भी कई यात्राएँ की होंगी। अपनी किसी यात्रा के खटूटे-मीठे अनुभव लिखिए। (3)

अथवा

कविता 'सुदामाचरित' के आधार पर बताइए कि कृष्ण ने सुदामा के आत्मसम्मान की रक्षा कैसे की? आप अपने मित्र की मुसीबत के समय कैसे सहायता करते हैं?

प्र12. निम्नलिखित प्रश्नों के उत्तर दीजिए : (2x3=6)

(क) मामाजी की गाड़ी के हॉर्न की आवाज़ सुनकर आसपास के वातावरण में क्या बदलाव आया? 'अनोखा हॉर्न' कहानी के आधार पर बताइए।

(ख) मामाजी को तीरंदाजी का शौक कैसे चढ़ा? कहानी 'तीरंदाजी का कमाल' के आधार पर बताइए।

(ग) फोटो खींचते समय मामाजी की वेशभूषा कैसी थी? कहानी 'फोटोग्राफी की धुन' के आधार पर बताइए।

प्र13. मामाजी की फोटोग्राफी का क्या परिणाम निकला? क्या आपने भी कभी ऐसा शौक अपनाया है? उसका क्या परिणाम हुआ? (4)

अथवा

कहानी 'तीरंदाजी का कमाल' के आधार पर बताइए कि मामाजी ने चोरों को कैसे पकड़वाया? क्या आपने भी कभी किसी की सहायता की है? कैसे?

(खण्ड - घ)

प्र14. आप अपने जन्मदिन पर अपने मित्रों को बुलाना चाहते हैं। इस विषय पर चर्चा करते हुए अपनी माँ से बातचीत करते हैं। उसी बातचीत को संवाद के रूप में लिखिए। (4)

(4)

प्र15. 'शुद्ध देसी घी' के लिए सुंदर एवं आकर्षक विज्ञापन तैयार कीजिए। (3)

प्र16. नीचे दिए चित्र को देखकर 25-30 शब्दों में अनुच्छेद लिखिए। (3)



प्र17. अपनी छोटी बहन को योग के लाभ बताते हुए पत्र लिखिए। (5)

अथवा

आपने नदियों की 'स्वच्छता अभियान' पर एक लेख लिखा है। उस लेख को समाचार-पत्र में छपवाने का अनुरोध करते हुए संपादक को पत्र लिखिए।

प्र18. निम्नलिखित विषयों में से किसी एक विषय पर 250 शब्दों में निबंध लिखिए:

(5)

(क) स्वस्थ भारत : बदलता देश, बदलती सोच

(ख) इंटरनेट की बढ़ती उपयोगिता

(ग) अभ्यास जीवन में आवश्यक

SA-1 (CLASS-VIII)

9/2016

SUBJECT : MATHEMATICS

Time : 3 hrs

MM : 80

General Instructions :

- i) All questions are compulsory.
- ii) Read all questions very carefully.
- iii) Questions 1 to 10 carry 1 mark each.
- iv) Questions 11 to 18 carry 2 marks each.
- v) Questions 19 to 28 carry 3 marks each.
- vi) Questions 29 to 34 carry 4 marks each.

Q1. A card is drawn from a well shuffled pack of 52 playing cards. Find the probability of getting a face card.

Q2. How are prisms and cylinders alike?

Q3. Without adding, find the sum of $1 + 3 + 5 + 7 + 9 + 11$

Q4. Write the linear equation for the given statement :

Seema thinks of a number. When she multiplies it by 3 and then add 9, she gets 30.

Q5. Name the property used in

$$\frac{3}{7} \times \left(\frac{4}{9} - \frac{5}{3} \right) = \left(\frac{3}{7} \times \frac{4}{9} \right) - \left(\frac{3}{7} \times \frac{5}{3} \right)$$

Q6. Rectangle is a convex quadrilateral. Give reason.

Q7. How many diagonals does a regular hexagon has?

Q8. Write two rational numbers that are equal to their reciprocals.

Q9. The prime factorisation of a number is $2 \times 5 \times 5 \times 5$. Find the smallest number by which it should be divided to make it a perfect cube.

Q10. Find the measure of exterior angle of a regular polygon of 12 sides.

Q11. Are the following numbers perfect square? Give reason.

(a) 505050

(b) 23453

Q12. Solve: $\frac{x+1}{2x+3} = \frac{3}{8}$

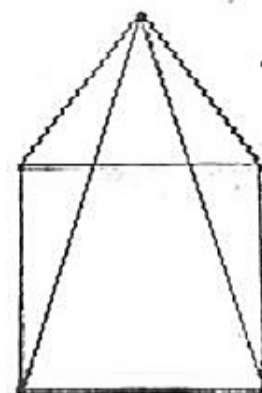

Q13. Name the given figure. Also write its number of faces, vertices and edges.

Q14. Sanchit makes a cuboid of plasticine of sides 7cm, 7cm and 2cm. How many such cuboids will be needed to form a cube?

Q15. Find the smallest number which must be subtracted from 405 so as to get a perfect square.

Q16. Represent $\frac{9}{5}$ on the number line.

Q17. Using Euler's formula find the number of vertices for a polyhedron whose number of faces and edges are 16 and 42 respectively.

Q18. The measures of two adjacent angles of a parallelogram are in the ratio 2:3. Find the measure of each of the angles of the parallelogram.

Q19. Using appropriate properties find $\frac{2}{5} \times \frac{1}{11} - \frac{1}{5} + \frac{2}{5} \times \frac{2}{11}$

Q20. The sum of three consecutive multiples of 3 is 225. Find the multiples.

Q21. In a right angled triangle ABC, $\angle B = 90^\circ$, AB = 24cm and BC = 10cm, find AC.

Q22. Find the smallest number by which 675 must be multiplied to obtain a perfect cube.

Q23. Verify Euler's formula for a triangular prism.

Q24. A box contains 7 blue, 8 white and 5 black marbles. If a marble is drawn at random from the box, what is the probability that it will be (a) black? (b) not black? (c) green?

Q25. In the given figure both ABCD and PQRS are parallelograms. Find the value of x .

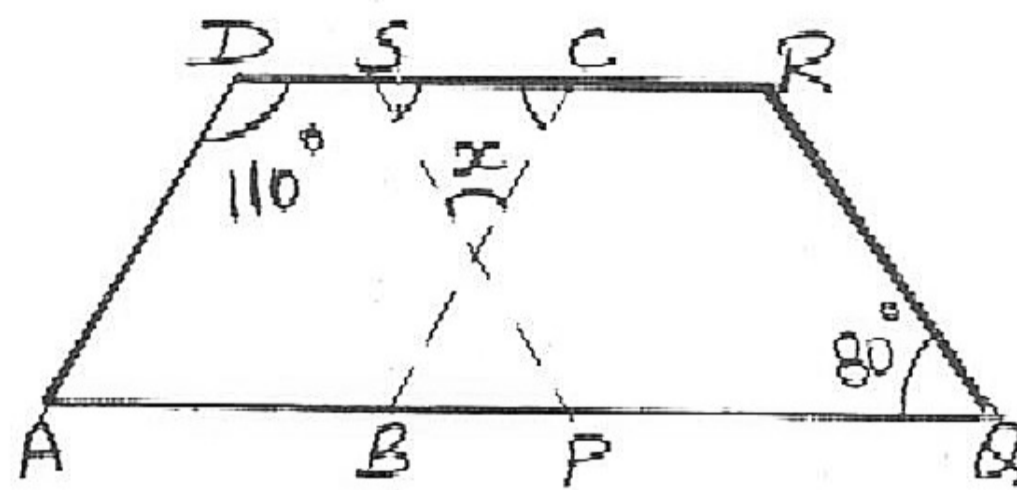

Q26. Half of the group of children are playing in the park and one fourth of them are busy in studies. The rest 9 are doing yoga. Find the total number of children in the group.

Q27. The given data shows the distribution of weights of 45 students of class VIII

Weight (in kg)	40-50	50-60	60-70	70-80
Number of Students	10	22	10	3

Draw a histogram for the given data.

Q28. Draw the top view, front view and side view of the given figure.

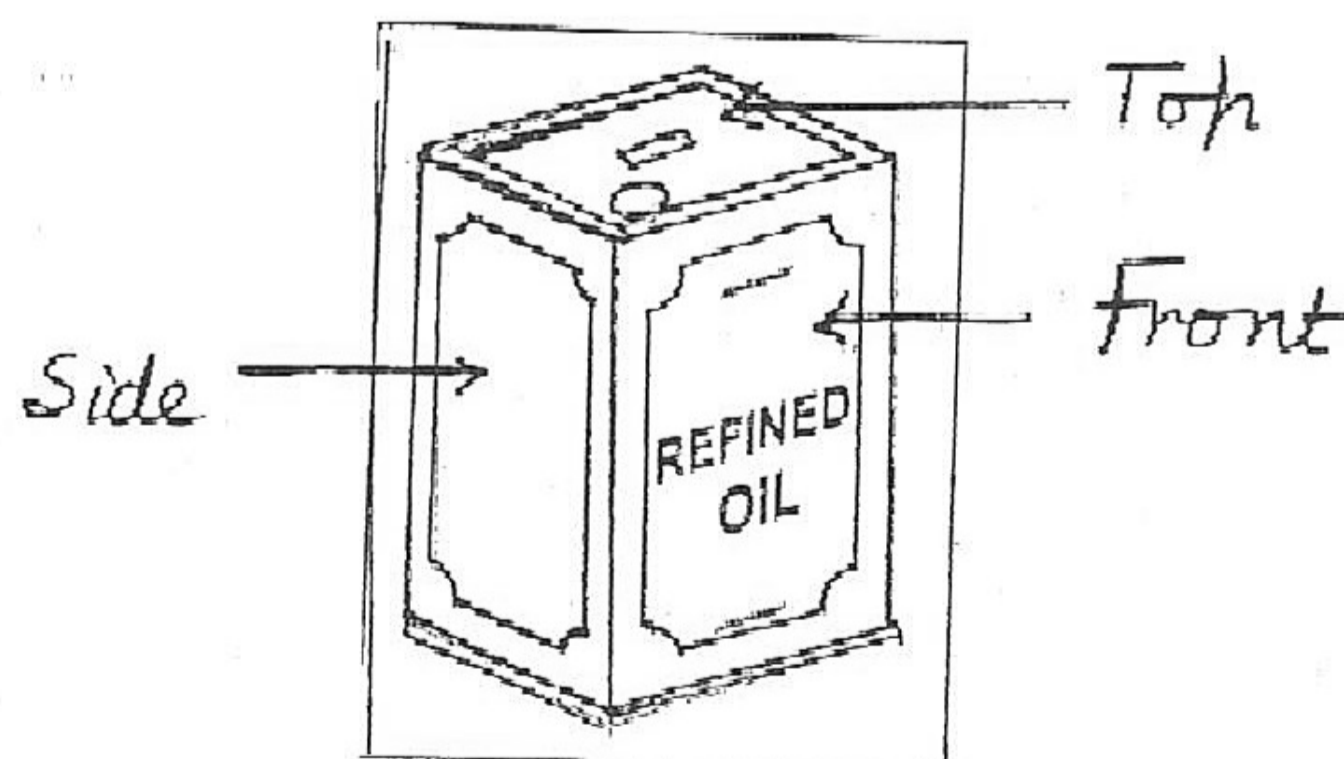

Q29. Find the cube root of

- (a) 1728 by Prime Factorisation Method.
- (b) 39304 by Estimation Method.

Q30. Solve the equation and check your result :

$$10x + 7 = 3x - 28$$

Q31. In a school, students of class 8 collected rupees 9216 to give donation to an NGO working for the education of poor children. If each student donated as many rupees as the number of students in class 8.

- (a) Find the number of students.
- (b) Which value of students is depicted here?

Q32. The following data shows the overhead expenses in a restaurant.

Items	Rent	Labour	Electricity	Billing	Decor
Amount (in ₹)	10000	8000	9000	6000	3000

Draw a pie-chart to represent the above data.

Q33. Find ten rational numbers between $\frac{-1}{5}$ and $\frac{1}{4}$.

Q34. 'CLUE' is a rhombus. If $CL = 5\text{cm}$, $OE = 4\text{cm}$, $OU = 3\text{cm}$ and $\angle ECL = 120^\circ$, find the following :

- (a) Length of LU.
- (b) Length of diagonal EL
- (c) measure of $\angle EOU$
- (d) measure of $\angle EUL$.

Give reason for each part.

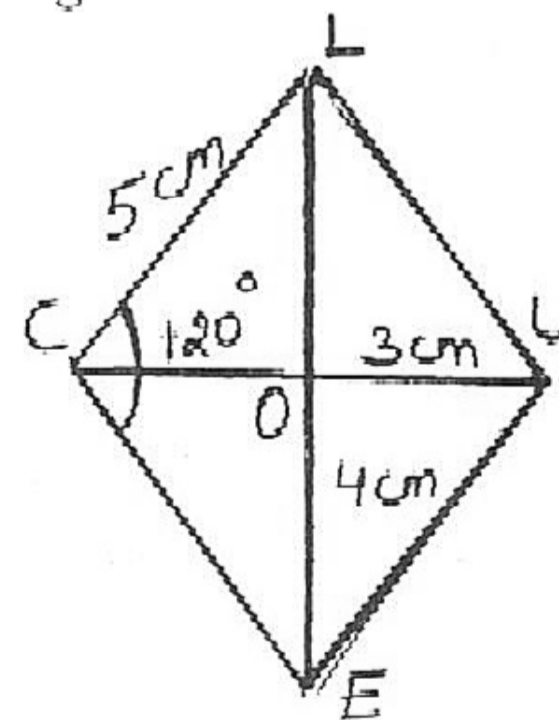

SA-1 (CLASS-VIII)

9/2016

SUBJECT : INTEGRATED SCIENCE

Time : 2½ hours

MM : 80

General Instructions :

- i) This paper consists of three sections A, B and C.
- ii) Marks are indicated against each question.
- iii) Draw neat and well labelled diagrams wherever required.

SECTION-A (PHYSICS)

- Q1. Answer in one word or one sentence : (5x1=5)
- (a) Give one similarity between magnetic force and electrostatic force.
 - (b) Why can't the astronauts talk to each other on the surface of moon?
 - (c) During the construction of a building, the lightning conductor was left hanging in the air by mistake. Would it still be effective? Why or why not?
 - (d) What is the lowest frequency at which human beings can hear sound?
 - (e) The air around us exerts a lot of pressure on us. Why do our bodies not feel that atmospheric pressure?

- Q2. Answer briefly : (4x2=8)
- (a) An archer shoots an arrow in the air horizontally. However, after moving some distance, the arrow falls to the ground. Name the initial force that sets the arrow in motion. Explain why the arrow ultimately falls down.
 - (b) A butterfly flaps its wings at the rate of 40 times in 4 seconds. Find its time period and frequency of vibration.
 - (c) Look at the given figure and answer the following questions :
 - (i) Name the point from which water comes out with maximum pressure.

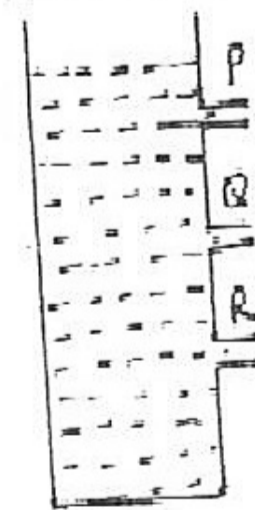

(1)

- (ii) Name the point from which water covers the minimum distance.

Justify your choices.

- (d) Can you hear the sound of an approaching train long before you see it by placing your ear on the metal track? Explain.

Q3. Answer the following :

(3x3=9)

- (a) Give an example where :-

- (i) a force moves a stationary body.
(ii) a force changes the speed of a moving body.
(iii) a force changes the direction of a moving body.

- (b) Name the device which is used to test whether an object is charged or not. Also draw its well labelled diagram.

- (c) Mr. David is the president of the Residents Welfare Association of your locality. The residents often complain about increasing noise pollution in the locality. List any three measures that can be taken to reduce this pollution.

Q4. Answer the following :

(1x5=5)

Seismograph is a device that records the waves of an earthquake.

- (a) Name the scale on which the intensity of an earthquake can be measured.
(b) What are seismic zones? Give examples of two areas that lie in these zones.
(c) Enlist two precautions that must be taken during an earthquake if you are at home.

SECTION-B (CHEMISTRY)

Q1. Answer in one word or one sentence each :

(5x1=5)

- (a) X is a gas produced when dilute hydrochloric acid is added to a reactive metal. Identify X. How can the gas X be tested for identification?

- (b) Fossil fuels should be conserved and used only when absolutely necessary. Give reason.
- (c) Name the following products of coal -
 - (i) It is an almost pure form of carbon and is used in the extraction of steel.
 - (ii) It has an unpleasant smell and is used to make naphthalene balls.
- (d) Complete the given equation :
Sulphur-di-oxide + water \rightarrow _____
- (e) Nitrogen : Fertiliser :: _____ : antiseptic

Q2. Answer briefly : (4x2=8)

- (a) Which physical property of metal correctly matches with the use of following items :
 - (i) aluminium foil (ii) wire
 - (iii) electric switch (iv) school-bell
- (b) A green layer is gradually formed on a copper plate left exposed to air for a week in a bathroom.
 - (i) What could this green substance be?
 - (ii) Write an equation for the above change.
- (c) Give reason :
 - (i) Sodium metal is stored in kerosene.
 - (ii) Petroleum is also called 'Black Gold'.
- (d) Bobby saw that the street lights were not switched off one morning. He asked his father to call the electricity department to ask them to switch off the lights.
 - (i) State the value shown by Bobby.
 - (ii) Which fuel was used for street lighting in the 19th century in New York and London?

Q3. Answer the following : (3x3=9)

- (a) On adding a piece of zinc metal to a blue-coloured solution of copper sulphate, Rahul observed that the colour of the solution changed from blue to colourless.

- (i) Explain the change involved in the given experiment. Write the word equation for it
- (ii) Name the type of reaction involved.
- (b) Coal is one of the earliest used fossil fuels. With reference to coal answer the following questions -
- (i) Define carbonisation.
- (ii) State two conditions required for formation of coal.
- (iii) Write any two uses of coal.
- (c) (i) Given below are examples of some elements. Classify them as metals and non-metals.
Sulphur, Carbon, Oxygen, Aluminium
- (ii) Reena collected a spoonful of rust and dissolved it in a very little amount of water. She obtained a solution which was then tested with red and blue litmus paper. What did she observe? Comment on the nature of the solution.

Q4. Answer the following : (5)

Look at the figure given below where petroleum and natural gas deposits are shown.

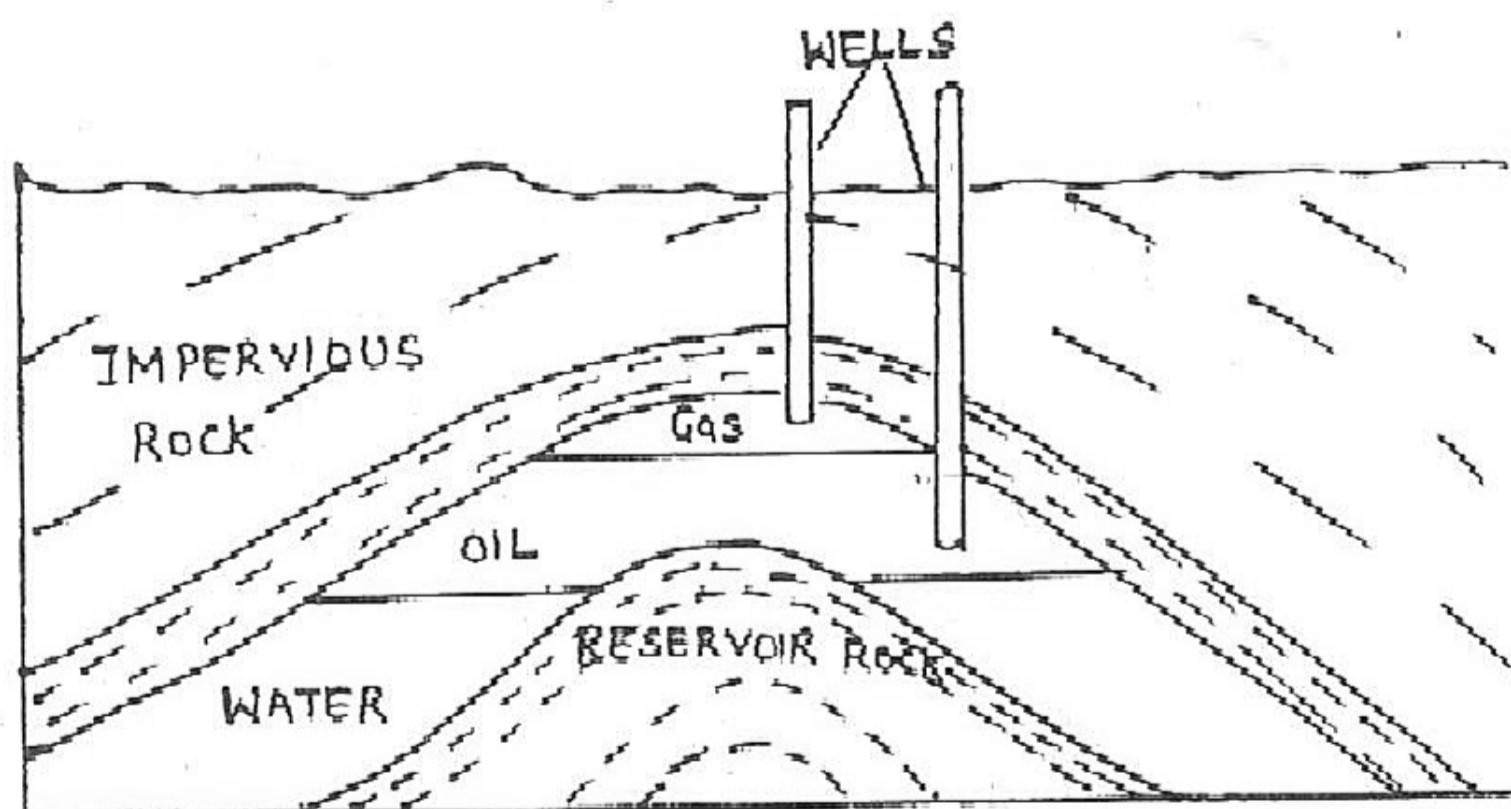

- (a) The process of separating various constituents or fractions of petroleum is called _____.

(4)

- (b) Layer containing petroleum oil and gas is obtained above that of water. Give reason.
- (c) Name the constituent of petroleum which is used as a -
- (i) solvent for dry cleaning
 - (ii) ointment
- (d) Many useful substances are obtained from petroleum and natural gas. What are these substances known as?
- (e) In India, the Petroleum Conservation Research Association advises people how to save petrol/diesel while driving. Write any two tips suggested by PCRA.

SECTION-C (BIOLOGY)

Q1. Answer in one word or one sentence : (4x1=4)

- (a) Freshly collected cow's milk spoils within a few hours at room temperature but the milk packed in a tetrapack stays fresh for a longer period of time. Give reason.
- (b) 'A' and 'B' are two wildlife sanctuaries located in the Pachmarhi Biosphere Reserve. Name A and B.
- (c) State one characteristic shown by amoeba and paramecium that classify them as an animal cell and not a plant cell.
- (d) Why should we avoid standing close to a tuberculosis patient while he/she is coughing?

Q2. Answer briefly : (4x2=8)

- (a) Identify the following diseases and name the causative organism of each :
- (i) It is spread by the bite of female Anopheles mosquito specially during the rainy season.
 - (ii) It is spread through air or contaminated water and can be prevented by administering oral drops of its vaccine.

- (b) 'X' are structures that appear only at the time of cell division in the cell. Name 'X' and state its function.
- (c) Give reason for the following :
- (i) Deforestation leads to floods.
 - (ii) Recycling of paper is beneficial to the environment.
- (d) Destruction of natural habitat of animals has led to the extinction of animals so much so that our national animal is also endangered. Name the project launched by the government to prevent their extinction. What is the objective of this project?

Q3. Answer the following : (3x3=9)

- (a) In the given diagram of the cell identify and label the following parts :

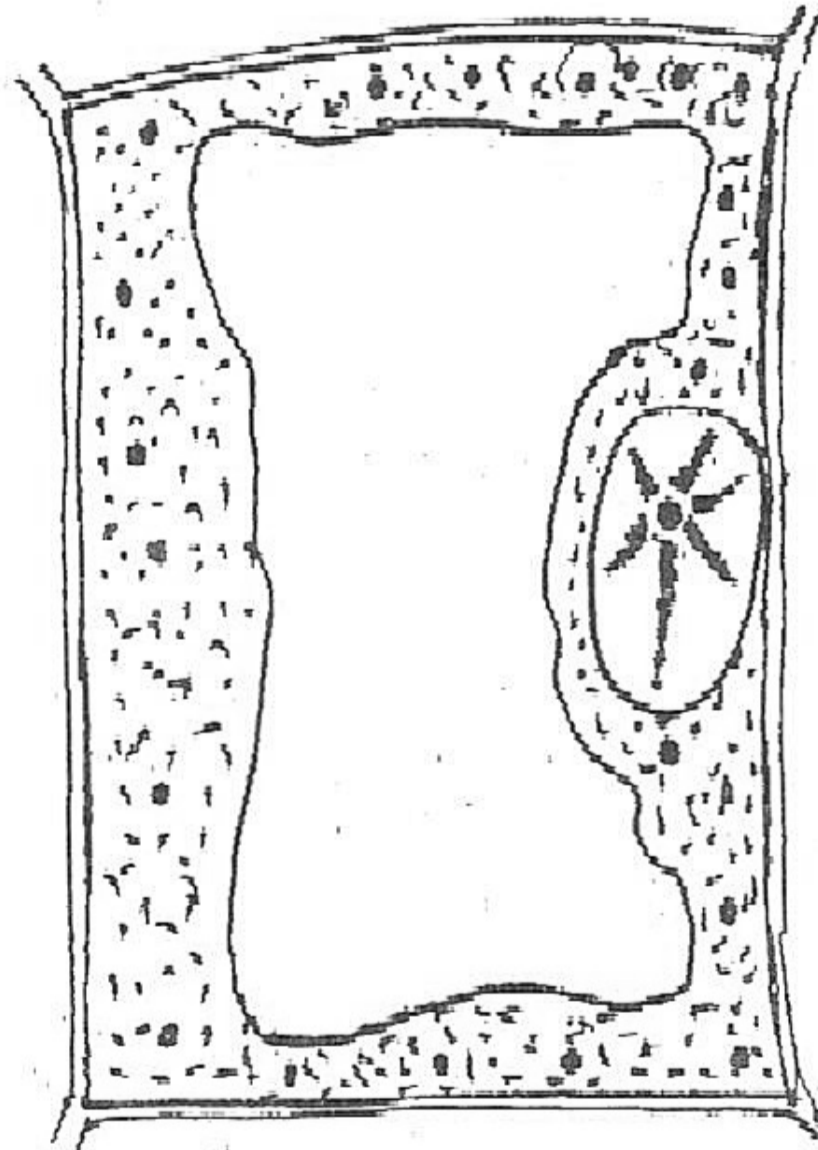

- (i) I am like a policeman. I do not allow anything and everything to get in and out of the cell.
- (ii) I act as a control centre of cellular activities.
- (iii) I am jelly like and various cell organelles are present in me.

- (b) 'Different shapes of the cells are related to their specific functions'. Name and draw three types of human cells to justify this statement.
- (c) (i) Fill the missing steps in the given flow chart.

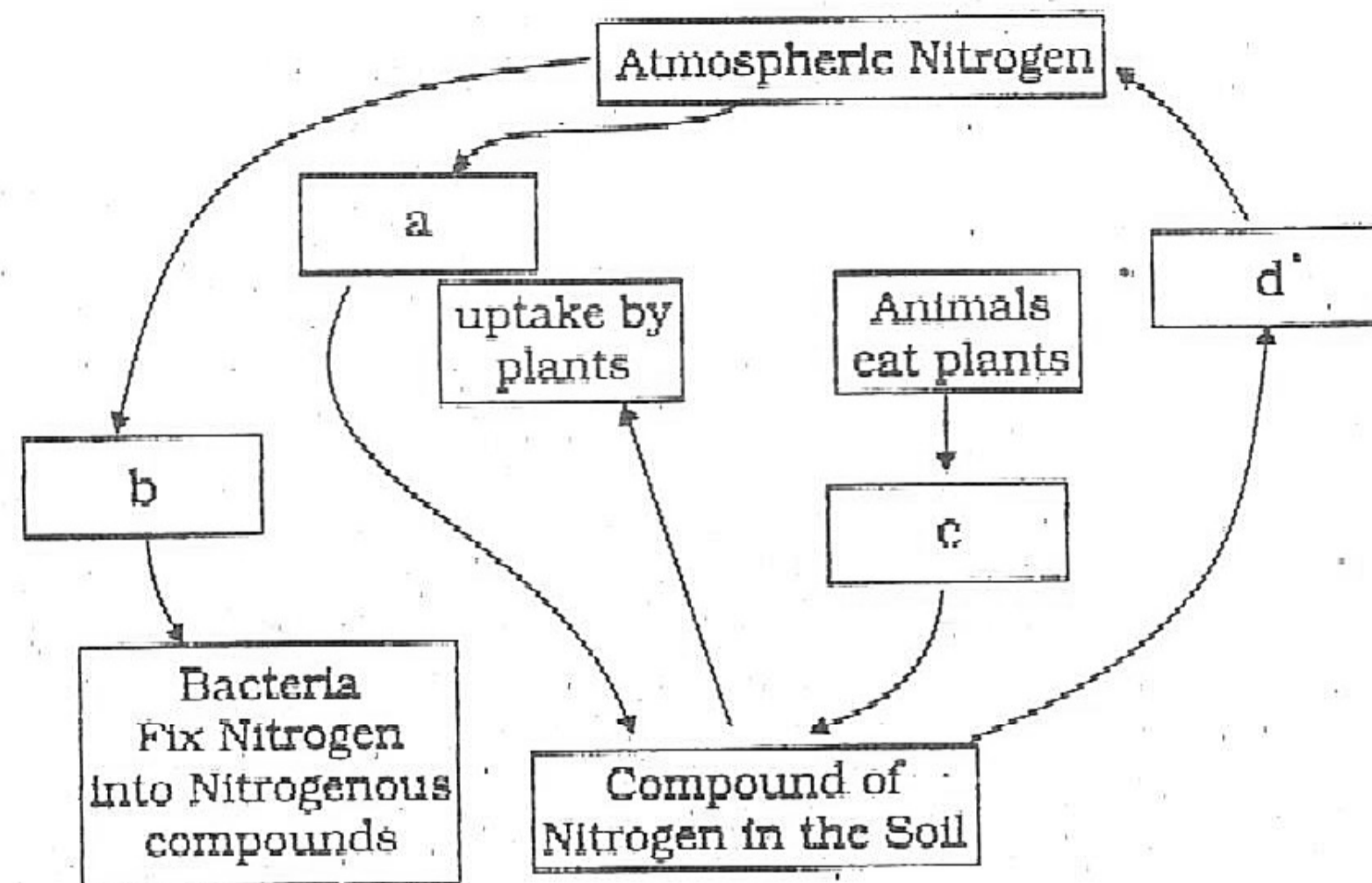

- (ii) Name any two constituents of all living organisms which have nitrogen as an important component.

Q4. Answer the following : (5)

- (a) Antibiotics are not effective against diseases like chickenpox and common cold. Why? Name any two antibiotics and write two precautions that should be taken while taking antibiotics.
- (b) Kushal's family is happy as he has become a proud father of a baby girl. In a routine visit to the hospital the doctor advised him not to skip the vaccination schedule.
- (i) What is a vaccine?
- (ii) Why are children given vaccination?

SA-1 (CLASS-VIII)

9/2016

SUBJECT : SOCIAL SCIENCE

Time : 3 hrs

MM : 80

General Instructions :

- i) Questions carrying 1 mark should be answered in one sentence.
- ii) Questions carrying 3 marks should be answered within 60-80 words.
- iii) Questions carrying 5 marks should be answered within 80-100 words.
- iv) Attach the maps properly to the main sheet.
- v) Multiple choice question is to be answered in the answer sheet.

Q1. Choose the correct answer from the options given below each question (7x1=7)

- (i) 'This young soldier of the British army was hanged to death for attacking his officers in Barrackpore.' Name him.
(a) Sitaram Pande (b) Nana Saheb
(c) Mangal Pandey (d) Peshwa Baji Rao
- (ii) An open prayer place of Muslims primarily meant for Id prayers is known as _____.
(a) Dargah (b) Khanqah
(c) Idgah (d) Cul-de-sac
- (iii) 'This battle became the first major victory of the East India Company in India'. Name it.
(a) Buxar (b) Plassey
(c) Awadh (d) Hyderabad

- (iv) Improving the quality of people's skills so that they are able to create more resources is known as _____.
- (a) Progressive development
 - (b) Investment
 - (c) Sustainable development
 - (d) Human resource development
- (v) Which fuel is referred to as 'Buried Sunshine'?
- (a) Natural Gas (b) Petroleum
 - (c) Coal (d) Kerosene
- (vi) Which among the following rights prohibits human trafficking, forced labour and children working under 14 years of age?
- (a) Right to Equality
 - (b) Right to Freedom
 - (c) Cultural and Educational Rights
 - (d) Right against Exploitation
- (vii) The act of breaking a law as well as the breach or infringement of Fundamental Rights is known as _____.
- (a) Acquit (b) Appeal
 - (c) Eviction (d) Violation

Q2. Answer the following questions in one sentence each:

(10x1=10)

- (i) Who discovered the sea route to India?
- (ii) What is meant by de-urbanisation?
- (iii) Name the two architects who designed New Delhi.
- (iv) Mention the main provision of 'Doctrine of Lapse'.

- (v) Enlist the factors on which the development of an actual resource depends.
 - (vi) What is meant by resource conservation?
 - (vii) Which country is the leading producer of copper in the world?
 - (viii) What do you mean by universal adult suffrage?
 - (ix) 'This scheme was introduced by the government to ensure right to food among children'. Name it.
 - (x) Who was the chairman of the drafting committee of the Indian constitution?
- Q3. Write a brief note on the administration of the East India Company in India. (3)
- Q4. Discuss the social and religious causes of the revolt of 1857. (3)
- Q5. How did partition affect life in Delhi? (3)
- Q6. 'The assumption of Diwani benefitted the East India company in many ways'. Discuss. (3)
- Q7. Why do we need to conserve minerals? (3)
- Q8. 'Resources can be classified into three broad categories'. Explain. (3)
- Q9. Differentiate between potential resources and actual resources. (3)
- Q10. Write a short note on three organs of the government. (3)
- Q11. What are the functions performed by Judiciary? (3)
- Q12. 'The Indian Parliament plays a key role in the functioning of a democracy'. Explain. (3)

Q13. State the outcomes of the Revolt of 1857. (5)

Q14. Distinguish between conventional and non-conventional sources of energy. (5)

Q15. What is meant by sustainable development? List the principles of sustainable development. (1+4=5)

Q16. Explain the key features of the Indian Constitution. (5)

Q17. (a) What is the composition of the Indian Parliament?

(b) How do elections of the Parliament take place? (2+3=5)

Q18. Attempt the following maps :

(a) On the provided outline political map of India, name and mark the following : (4x1=4)

(i) State ruled by Tipu Sultan

(ii) An area conquered by Doctrine of lapse.

(iii) State having deposits of gold in India.

(iv) State having deposits of high grade iron-ore.

(b) On the provided outline political map of the world, name and mark the following : (4x1=4)

(i) Largest producer of bauxite.

(ii) First country to develop hydroelectricity.

(iii) Continent where slave trade began.

(iv) Portuguese base in India.

SA-1 (CLASS-VIII)
SUBJECT : FRENCH

8/2016

Time : 3 hrs

MM : 80

General Instructions :

- (i) Read all the questions carefully.
- (ii) Number the answers as given in the question paper.
- (iii) Write in a neat and clear handwriting.
- (iv) Write the answers in complete sentences.

SECTION-A [COMPRÉHENSION ÉCRITE]

A1. Lisez :

Moi. Je m'appelle Lisa. J'ai 15 ans. J'ai appris la langue française. Maintenant, je travaille à l'école. Je parle français et anglais. J'aime voyager. J'aime conduire la voiture.

Ma copine, Nathalie a 15 ans aussi. Nous avons le même âge. Avant, elle a travaillé au bureau. Maintenant, elle ne travaille pas. Elle est aussi bilingue comme moi. Elle parle italien et français. Nous parlons français ensemble. Depuis 5 ans, elle habite à Paris. Mais, elle a décidé de trouver le travail en Inde. J'attends Nathalie.

Mon copain, Marc habite à Paris. Il a 16 ans. Il parle trois langues : français, allemand et italien. Marc et Nathalie parlent italien quand ils sont ensemble, mais je ne comprends pas! Donc je commence à apprendre la langue italienne aussi.

A1.1 Répondez :

(2x1=2)

- (a) Est-ce que Nathalie travaille maintenant?
- (b) Lisa, qu'est-ce qu'elle aime faire?

A1.2 Écrivez deux verbes au passé composé avec 'avoir' du texte :

(2x1=2)

- (a) _____ (b) _____

A1.3 Dites Vrai ou Faux :

(4x1=4)

- (a) Marc conduit sa voiture.

(1)

- (b) Lisa peut parler allemand.
- (c) Depuis 5 ans, Nathalie vit en France.
- (d) Avant, Nathalie a travaillé dans un bureau.

A2. Lisez :

L'Inde est un beau pays très grand avec un climat varié. C'est un pays riche en histoire et en littérature. Delhi est la capitale de l'Inde. C'est une ville historique avec de beaux monuments et jardins. La ville est très grande et belle. L'Inde a 22 langues officielles. En Inde, il y a beaucoup de fleuves et montagnes. Mumbai, Chennai, Delhi etc sont d'autres villes importantes d'Inde. Une autre ville en Inde est Pondichéry. Nous parlons français à Pondichéry. C'est un petit état dans le sud de l'Inde.

A2.1 Dites Vrai ou Faux : (4x1=4)

- (a) Delhi est la capitale de France.
- (b) Inde est un pays riche en histoire.
- (c) Il y a plus de 20 langues officielles en Inde.
- (d) Pondichéry est une ville française.

A2.2 Écrivez le contraire : (2x1=2)

- (a) petit ≠
- (b) laide ≠

A2.3 Nommez deux villes en Inde. (1)

SECTION-B [EXPRESSION ÉCRITE]

B1. Nommez les cinq pays francophones avec leurs capitales. (5)

B2. Vous invitez votre ami(e) pour votre anniversaire. Rédigez cette invitation (30 mots). (5)

B3. Vous avez des examens la semaine prochaine. Écrivez cinq instructions que vos parents vous disent. (Utilisez l'impératif). (5)

B4. Faites des phrases : (5x1=5)

- (a) télévision
- (b) école
- (c) organiser
- (d) pain
- (e) acheter

SECTION-C (GRAMMAIRE)

- C1. Choisissez la bonne réponse : (10x½=5)
- (a) J'aime _____ (ses, mes, tes) meubles.
 - (b) _____ (cet, ce, cette) robe est belle.
 - (c) Je prépare _____ (tous, tout, toutes) les examens.
 - (d) Il faut jeter _____ (cette, ces, cet) fleurs.
 - (e) Mets-tu _____ (cette, ces, ce) manteaux dans _____ (cette, ces, ce) armoire?
 - (f) _____ (tous, toute, tout) le monde entre dans cet opéra.
 - (g) Nous travaillons _____ (tout, tous, toute) la journée.
 - (h) Ils donnent _____ (nos, vos, leurs) livres à _____ (leur, notre, votre) copine.
- C2. Reliez les phrases en utilisant : (5x1=5)
et, parce que, puis, ou, donc
- (a) Je vais chez le médecin; j'ai de la fièvre.
 - (b) Voulez - vous du poulet; du mouton?
 - (c) Elle aime nager; jouer au tennis.
 - (d) Elle se réveille à sept heures; elle se brosse les dents.
 - (e) Il n' y a pas de viande; elle va à la boucherie.
- C3. Mettez les phrases au négatif : (3x1=3)
- (a) Ce sont des travaux difficiles.
 - (b) Vous rangez votre chambre.
 - (c) Nous allons finir ce travail à 6h.
- C4. Conjuguez les verbes au passé composé avec 'avoir'. (3x1=3)
- (a) Elles _____ leur travail. (finir)
 - (b) Son grand-père _____ un vélo à Marie. (donner)
 - (c) J' _____ un bon roman. (lire)
- C5. Changez ces phrases à l'impératif : (3x1=3)
- (a) (écouter) tes professeurs.

(b) (être) dans notre classe.

(c) (savoir) bien vos leçons.

C6. Mettez les phrases à l'interrogative avec l'inversion :

(3x1=3)

(a) Tu as pris beaucoup d'argent.

(b) Vous avez acheté des stylos.

(c) Il est allé au bureau.

C7. Mettez au pluriel :

(2x1=2)

(a) Je porte ma robe.

(b) Il a une maison blanche.

C8. Écrivez le participe passé du verbe :

(4x½=2)

(a) avoir = _____

(b) venir = _____

(c) mettre = _____

(d) rester = _____

C9. Mettez les phrases en ordre :

(2x1=2)

(a) la / maison / Vous / à / êtes

(b) à / Ils / Rome / rentrent

C10. Chassez l'intrus :

(2x1=2)

(a) mourir, aller, revenir, parler

(b) disons, dites, dire, dit

SECTION-D (LA CULTURE ET LA CIVILISATION)

D1. Dites Vrai ou Faux :

(5x1=5)

(a) Caroline vient de Belgique.

(b) Elsa essaie une jupe rouge et un t-shirt.

(c) François a passé un week-end magnifique.

(d) Aladin a un tigre.

(e) Le petit chaperon rouge a pris un pot de fromage.

D2. Choisissez la bonne réponse :

(5x1=5)

(a) John est allé au théâtre pour voir :

(i) une pièce

(ii) un film

(iii) un jeu de rôle

- (b) Marie a apporté _____ pour Denis.
- (i) un veston (ii) une montre
(iii) un vélo
- (c) Patricia est le professeur de :
- (i) musique (ii) anglais
(iii) français
- (d) Pauline a rendu visite à ses grands-parents :
- (i) aux champignons (ii) au champagne
(iii) à la campagne
- (e) La maman d'Elsa paie par :
- (i) la carte (ii) L'argent liquide
(iii) le chèque

D3. Répondez aux questions : (2x1=2)

- (i) Qui sauve la Blanche - Neige?
(ii) Qu'est-ce que Maman a fait le matin dans la leçon <<Mon dernier week-end>>?

D4. Reliez les colonnes : (6x½=3)

- | A | | B | |
|-----------------------------|----------------------|----------------------|--|
| (a) Le petit chaperon rouge | (i) un pays | (i) un pays | |
| (b) Le manteau | (ii) un conte | (ii) un conte | |
| (c) Le gâteau | (iii) un vêtement | (iii) un vêtement | |
| (d) La France | (iv) un anniversaire | (iv) un anniversaire | |
| (e) noire | (v) un verbe | (v) un verbe | |
| (f) aller | (vi) une couleur | (vi) une couleur | |

विषयः - संस्कृतम्

कक्षा : VIII

समयः - होरात्रयम्

पूर्णाङ्कः - 80

- निर्देशाः (i) अस्मिन् प्रश्नपत्रे चत्वारः खण्डाः सन्ति ।
(ii) प्रतिखण्ड - उत्तराणि पृथक् प्रदत्तायाम् उत्तरपुस्तिकायां लेखनीयानि ।
(iii) प्रत्येकं खण्डं अधिकृत्य उत्तराणि एकस्मिन् स्थाने क्रमेण लेखनीयानि ।
(iv) प्रश्नपत्रे उत्तराणि न लेखनीयानि ।
(v) प्रश्नसंख्या प्रश्नापत्रानुसारं अवश्यमेव लेखनीया ।
(vi) सर्वेषां प्रश्नानां उत्तराणि संस्कृतेन लेखनीयानि ।

खण्डः 'क' (अपठित-अवबोधनम्)

अंकाः 10

प्र1. अधोलिखितम् अनुच्छेदं पठित्वा प्रदत्तप्रश्नानां उत्तराणि लिखत -

अस्मिन् संसारे शक्तेः महिमा सर्वत्र दृश्यते । शक्तिं विना न सिध्यति किमपि कार्यम् । इयं शक्तिः बहुविधा वर्तते - शरीरशक्तिः, बुद्धिशक्तिः, धनशक्तिः, जनशक्तिः, सैन्यशक्तिः, राष्ट्रशक्तिः च । सर्वासु शक्तिषु बुद्धिशक्तिः एव श्रेष्ठा । यस्य शारीरिकं बलं स्यात् परं बुद्धिः न स्यात्, तस्य तत् बलं व्यर्थम् एव । बलवान् अपि गजः बुद्धिमत्ता मनुष्येण वशम् आनीयते । भयानकः अपि सिंहः बुद्धिबलात् पञ्जरबद्धः क्रियते । बुद्धिं विना सिद्धिः न मिलति । बुद्ध्या एव विद्या प्राप्यते, बुद्ध्या एव यंत्राणि निर्मायन्ते । यद्यपि संघे शक्तिः कलौ युगे इति कथितं तथापि तत्रापि बुद्धेः महती आवश्यकता । अतएव कस्यापि संघस्य संचालनं बुद्धिमन्तं नेतारम् अपेक्षते । परं बुद्धिः तु सा एव हितकारिणी या सन्मार्गम् अनुसरति । इयं एव जीवनस्य उपलब्धिः ।

I. एकपदेन उत्तरत -

(4x½=2)

- (i) बुद्धिं विना का न मिलति?
(ii) संसारे कस्याः महिमा दृश्यते?
(iii) बुद्ध्या एव कानि निर्मायन्ते?
(iv) सर्वासु शक्तिषु का श्रेष्ठा?

II. पूर्णवाक्येन उत्तरत -

(2x2=4)

- (i) बलवान् अपि गजः केन वशम् आनीयते?
(ii) कस्य बलं व्यर्थं भवति?

III. यथानिर्देशम् उत्तरत -

(4x½=2)

- (i) 'भयानकः सिंहः' अनयोः पदयोः विशेषणपदं किम् अस्ति?
(ii) 'लोके' अस्य किम् पर्यायपदम् अत्र प्रयुक्तम्?
(iii) 'मिलति' क्रियापदस्य कर्तृपदम् किम् अस्ति?
(iv) 'कुमार्गम्' अस्य किम् विलोमपदम् अत्र प्रयुक्तम्?

IV. अस्य गद्यांशस्य कृते उचितं शीर्षकं लिखत ।

(2)

- प्र2. स्वाध्ययन-प्रगतिविषये ज्येष्ठभ्रातरम् प्रति लिखितं पत्रं मञ्जूषायां प्रदत्तैः उचितपदैः पूरयित्वा उत्तरपुस्तिकायां पुनः लिखत -
(10x½=5)

मञ्जूषा

दुर्बलता, दर्शनीयः, भ्रातः, विद्यालये, प्रतिदिनं, पत्रं, फरीदाबादतः, प्रणामाः, संस्कृतविषये, भवदीयः

(i) _____

तिथिः _____

पूज्य (ii) _____

सादरं नमामि ।

अत्र कुशलम् तत्रास्तु । अत्र भवता प्रेषितं (iii) _____ प्राप्तम् । अहं (iv) _____ प्रातः पञ्चवादनसमये उत्थाय सप्तवादनपर्यन्तं (v) _____ पठितानां पाठानां आवृत्तिं गृहकार्यं च करोमि । (vi) _____ अहं कक्षायां प्रथमः अस्मि । गणितविषये मम (vii) _____ अधुना दूरीभूता । मम सुलेखः अपि (viii) _____ सज्जातः । पितृचरणयोः मम (ix) _____ ।

(x) _____

कृष्णः

- प्र3. अधः प्रदत्तं चित्रम् आधृत्य मञ्जूषायां प्रदत्तशब्दानां सहायतया पञ्चसंस्कृतवाक्यानि लिखत - (5x2=10)

मञ्जूषा

नदीतटस्य, आकाशे, क्षालयति, जनाः, सूर्यः, नमस्कारं, वस्त्राणि, वृक्षाः, नरः, खगाः, नदीजले, उत्पतन्ति

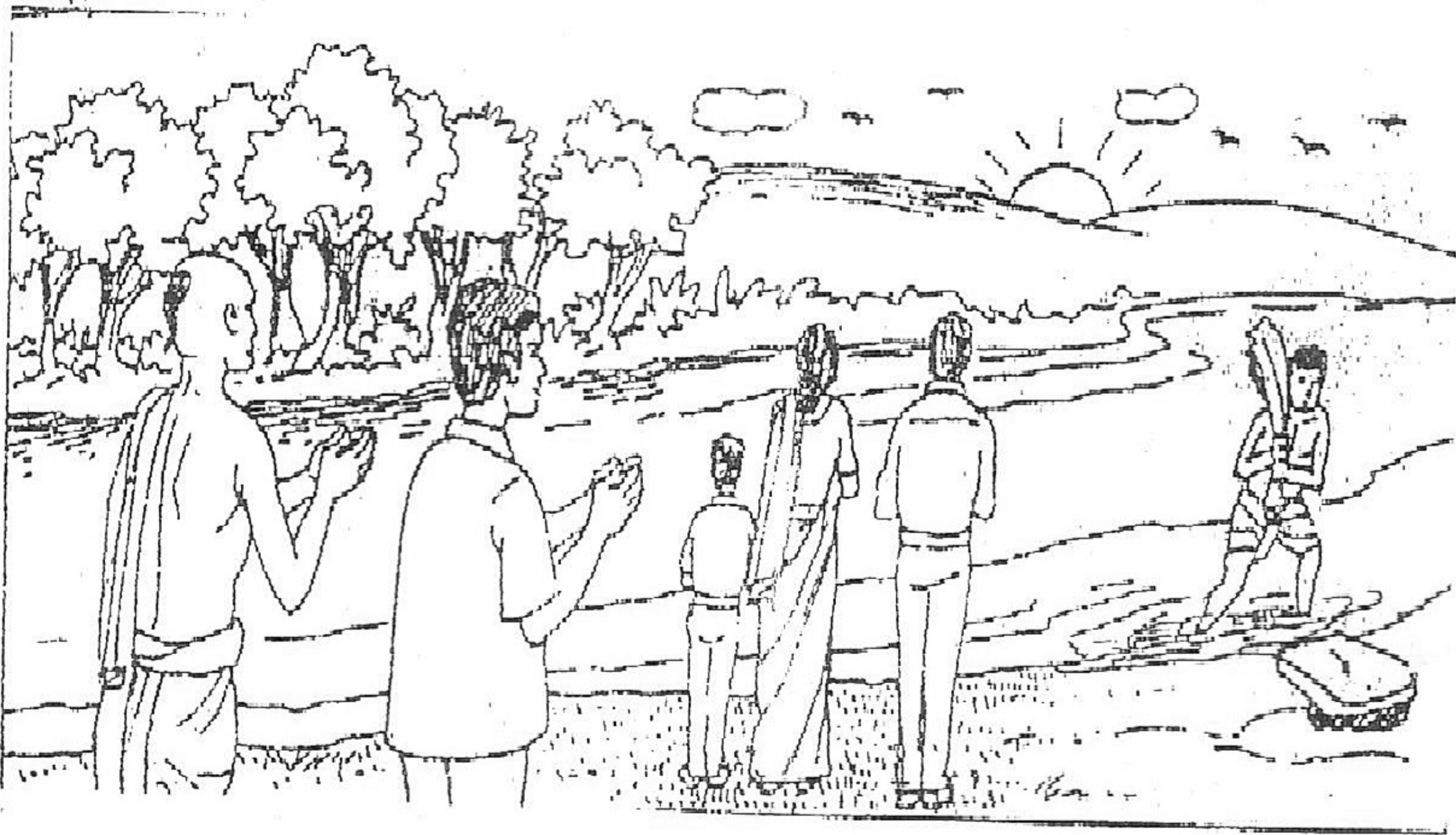

(C-2)

- प्र4. अधोलिखितवाक्येषु रेखांकितपदेषु सन्धिं सन्धिच्छेदं वा कृत्वा पुनः पूर्णवाक्यं लिखत - (4x1=4)
- इदं तव + एव गृहम् अस्ति ।
 - अस्माकं पुस्तके सु + उक्तयः अपि सन्ति ।
 - विद्यार्थी पाठं पठति ।
 - प्रत्येकं कार्यं ध्यानेन कुरु ।
- प्र5. निम्न-उपसर्गान् धातून् च संयोज्य विभज्य वा लिखत - (4x1=4)
- छात्रः शिक्षकं अनु + गम् ।
 - जनाः उद्याने वि + चर् ।
 - सूर्यः तमः अपनयति ।
 - चन्द्रः पृथ्वीं परिभ्रमति ।
- प्र6. (क) अधोलिखितवाक्ययोः रेखांकितपदस्य प्रकृति-प्रत्ययौ पृथक् पृथक् कृत्वा अथवा संयोज्य पुनः वाक्यानि लिखत - (2x1=2)
- अहं अमृतं पा + तुमुन् इच्छामि ।
 - स इदं कार्यं कर्तुम् इच्छति ।
- (ख) तुमुन् प्रत्ययं संयोज्य वाक्यसंयोजनं क्रियताम् - (2x1=2)
- बालकः पुस्तकं ददाति । सः मित्रस्य गृहं गच्छति ।
 - गीता ईश्वरं नमति । स देवालयं गच्छति ।
- प्र7. कोष्णातशब्देषु उचितविभक्तिं प्रयुज्य वाक्यानि उत्तरपुस्तिकायां लिखत - (4x1=4)
- अलम् _____ । (विवाद)
 - _____ बहिः मा गच्छ । (गृह)
 - _____ परितः पुष्पाणि सन्ति । (विद्यालय)
 - _____ रमेशः कुशलः अस्ति । (छात्र)
- प्र8. उचितशब्दरूपैः रिक्तस्थानानि पूरयित्वा वाक्यानि पुनः लिखत - (4x1=4)
- अद्य बालिका _____ सह विद्यालयं गमिष्यति । (पितृ - तृतीया विभक्तिः, एकवचनम्)
 - _____ भ्राता अस्मिन् विद्यालये पठति । (अस्मद्)
 - भक्ताः _____ स्नानं कुर्वन्ति । (नदी - सप्तमी विभक्तिः, एकवचनम्)
 - _____ कुत्र गच्छथः । (युष्मद्)
- प्र9. उचितधातुरूपैः रिक्तस्थानानि पूरयित्वा वाक्यानि पुनः लिखत - (5x1=5)
- त्वं पाकशालायां सूपं _____ । (पच् - लोट् लकारे)
 - यूयं क्रीडितुम् न _____ ? (इष्)
 - सः विद्यालयं _____ । (गम् - विधिलिङ् लकारे)

(iv) ह्यः मम माता भोजनम् न _____ । (पच)

(v) श्वः अहं व्यायामं _____ । (कृ)

खण्डः 'घ' (पठित-अवबोधनम्)

अंकाः 30

प्र10. अधोलिखितं गद्यांशं पठित्वा प्रदत्तप्रश्नानां उत्तराणि लिखत -

(5)

आसीत् कश्चित् चञ्चलो नाम व्याधः । पक्षिमृगादीनां ग्रहणेन सः स्वीयां जीविकां निर्वाहयति स्म । एकदा सः वने जालं विस्तीर्य गृहम् आगतवान् । अन्यस्मिन् दिवसे प्रातःकाले यदा चञ्चलः वनं गतवान् तदा सः दृष्टवान् यत् तेन विस्तारिते जाले दौर्भाग्यात् एकः व्याघ्रः बद्धः आसीत् । सौचिन्तयत्, 'व्याघ्रः मां खादिष्यति अतएव पलायनं करणीयम्' ।

I. एकपदेन उत्तरत -

(2x½=1)

(i) विस्तृते जाले कः बद्धः आसीत्?

(ii) व्याधस्य किम् नाम आसीत्?

II. पूर्णवाक्येन उत्तरत -

(2x1=2)

(i) चञ्चलः किम् अचिन्तयत्?

(ii) सः स्वीयां जीविकां केन निर्वाहयति स्म?

III. यथानिर्देशम् उत्तरत -

(4x½=2)

(i) 'खादिष्यति' इति क्रियापदस्य कर्तृपदं किम् अस्ति?

(ii) 'दिने' अस्य किं पर्यायपदम् अत्र प्रयुक्तम्?

(iii) 'विस्तारिते जाले' अनयोः पदयोः विशेषणपदं किम् अस्ति?

(iv) 'सौभाग्यात्' अस्य किं विलोमपदम् अत्र प्रयुक्तम्?

प्र11. अधोलिखितं पद्यांशं पठित्वा प्रदत्तप्रश्नानाम् उत्तराणि लिखत -

(5)

गुणा गुणज्ञेषु गुणा भवन्ति

ते निर्गुणं प्राप्य भवन्ति दोषाः ।

सुस्वादुतोयाः प्रभवन्ति नद्यः

समुद्रमासाद्य भवन्त्यपेयाः ॥

I. एकपदेन उत्तरत -

(2x½=1)

(i) कम् प्राप्य गुणाः दोषाः भवन्ति?

(ii) गुणाः कुत्र गुणाः भवन्ति?

II. पूर्णवाक्येन उत्तरत -

(2x1=2)

(i) कम् आसाद्य नद्यः अपेयाः भवन्ति?

(ii) नद्यः कीदृशाः प्रभवन्ति?

III. यथानिर्देशम् उत्तरत -

(4x½=2)

(i) 'गुणाः' अस्य कर्तृपदस्य क्रियापदं किम् अस्ति?

(ii) 'सागरम्' अस्य किं पर्यायपदम् अत्र प्रयुक्तम्?

(C-4)

(iii) 'सुस्वादुतोयाः नद्यः' अनयोः पदयोः विशेष्यपदम् किम् अस्ति?

(iv) 'दोषाः' अस्य किं विलोमपदम् अत्र प्रयुक्तम्?

प्र12. अधोलिखितं संवादं पठित्वा प्रदत्तप्रश्नानां उत्तराणि लिखत -

(5)

अध्यापिका - प्रदेशेऽस्मिन् हस्तशिल्पानां बाहुल्यं वर्तते। आवस्त्राभूषणेभ्यः गृहनिर्माणपर्यन्तं प्रायः वंशवृक्षनिर्मितानां वस्तूनाम् उपयोगः क्रियते। यतो हि अत्र वंशवृक्षाणां प्राचुर्यं विद्यते। साम्प्रतं वंशोद्योगोऽयं अन्ताराष्ट्रियख्यातिम् अवाप्तोऽस्ति।

अभिनवः - भगिनीप्रदेशोऽयं बह्वाकर्षकः ज्ञायते?

सलीमः - किं भ्रमणाय भगिनीप्रदेशोऽयं समीचीनः?

सर्वे छात्राः - (उच्चैः) महोदये! आगामिनी अवकाशे वयं तत्रैव गन्तुम् इच्छामः।

स्वरा - भवत्यपि अस्माभिः सार्द्धं चलतु।

अध्यापिका - रोचते मेऽयं विचारः। एतानि राज्यानि तु भ्रमणार्थं स्वर्गसदृशानि इति।

I. एकपदेन उत्तरत -

(2x½=1)

(i) एतानि राज्यानि भ्रमणार्थं कीदृशानि सन्ति?

(ii) अस्मिन् प्रदेशे केषां बाहुल्यं वर्तते?

II. पूर्णवाक्येन उत्तरत -

(2x1=2)

(i) सर्वे छात्राः कदा तत्र गन्तुम् इच्छन्ति?

(ii) सलीमः किं पृच्छति?

III. यथानिर्देशम् उत्तरत -

(4x½=2)

(i) 'अधुना' अस्य किम् पर्यायपदम् अत्र प्रयुक्तम्?

(ii) 'आगन्तुम्' अस्य किं विलोमपदम् अत्र प्रयुक्तम्?

(iii) 'एतानि राज्यानि' अनयोः पदयोः विशेषणपदं किम् अस्ति?

(iv) 'वयं तत्रैव गन्तुम् इच्छामः' अत्र इच्छामः क्रियापदस्य कर्तृपदम् किम् अस्ति?

प्र13. अधोलिखित-श्लोकस्य अन्वयम् उचितक्रमेण पूरयित्वा उत्तरपुस्तिकायां पुनः लिखत -

(4x1=4)

पीत्वा रसं तु कटुकं मधुरं समानं

माधुर्यमेव जनयेन्मधुमक्षिकासौ।

सन्तस्तथैव समसज्जनदुर्जनानां

श्रुत्वा वचः मधुरसूक्तरसं सृजन्ति ॥

अन्वयः - असौ मधुमक्षिका तु कटुकं (i) _____ रसं समानं (ii) _____ माधुर्यम् एव जनयेत्।

तथा एव सन्तः समसज्जनदुर्जनानां वचः (iii) _____ मधुरसूक्तरसं (iv) _____।

प्र14. अधोलिखितकथनेषु रेखांकितपदम् आधृत्य प्रश्ननिर्माणं कुरुत -

(4x1=4)

(i) गुहा उच्चैः शृगालम् आह्वयत्।

(ii) एका शिक्षिका गृहात् पुस्तकानि आदाय चलति।

(iii) इयं महाराष्ट्रस्य प्रथमा कन्यापाठशाला अस्ति ।

(iv) चञ्चलः नदीजलम् अपृच्छत् ।

(8x½=4)

प्र15. अधोलिखितवाक्यानि घटनाक्रमानुसारेण पुनः लिखत -

(i) दूरं पलायमानः शृगालः श्लोकम् अपठत् ।

(ii) सिंहः शृगालस्य आह्वानम् अकरोत् ।

(iii) क्षुधार्तः सिंहः महतीं गुह्याम् अपश्यत् ।

(iv) सर्वे पशवः भयभीताः अभवन् ।

(v) सिंहः अचिन्तयत् - नूनं रात्रौ कोऽपि जीवः गुह्याम् आगच्छति ।

(vi) दूरस्थः शृगालः रवं कर्तुम् आरभत ।

(vii) सिंहपदपङ्क्तिं दृष्ट्वा शृगालः अचिन्तयत् - विले सिंहः अस्ति ।

(viii) गुहा सिंहोच्चगर्जन - प्रतिध्वनिना प्रतिध्वनिता ।

(6x½=3)

प्र16. अर्थैः सह शब्दानाम् मेलनं कृत्वा उत्तरपुस्तिकायाम् पुनः लिखत -

शब्दाः

समवायः

नापितैः

जहाति

प्रयासम्

विलस्य

निखिलां

अर्थाः

त्यजति

गुह्याः

प्रयत्नम्

सम्पूर्णम्

समूहः

केशकर्तकैः

SUBJECT : COMPUTER SCIENCE

Time : 2 hrs

MM : 50

Q1. Choose the correct answer and write it in the answer sheet: (6x1=6)

- (a) This is not a container tag.
(i) <I> (ii) <HR>
(iii) <Body> (iv)
- (b) Tag that breaks the line and displays the text from the next line.
(i) <BG> (ii) <BK>
(iii)
 (iv) <TR>
- (c) It acts as a central point of connection for all the computers on a wired network.
(i) Hub (ii) Protocol
(iii) Network Card (iv) Network cable
- (d) The computers that are connected to the server are called _____.
(i) Nodes (ii) Laptop
(iii) PC (iv) Tablets
- (e) Year in which blogger was launched.
(i) 1990 (ii) 1999
(iii) 1995 (iv) 1994
- (f) He is known as the 'Father of the Internet'.
(i) Steve Jobs (ii) Vinton Gray
(iii) Bill Gates (iv) Narayan Murthy

Q2. Give one word answer for the following statements : (8x1=8)

- (a) Network architecture in which several computers are connected to the central server.

- (b) Name the attribute used with <HR> tag.
- (c) An example of plugin software used to play streaming audio/video files.
- (d) The protocol used to control the flow of information and exchange hypertext over the internet.
- (e) Name the attribute of <P> tag.
- (f) A computer network mainly created for individual person.
- (g) Name the most commonly used network card.
- (h) Internet service through which two users have simultaneous video conversation.

Q3. Answer the following questions :

- (a) What is HTML? (3)
- (b) Explain the use of 'Skype' software. Mention the basic requirements to use this software. (3)
- (c) What is the use of tag? Explain any two attributes used with tag. (3)
- (d) List any three advantages of networking. (3)
- (e) Explain the components required to establish wireless networking. (3)

Q4. Write a short note on : (4x2=8)

- (a) Peer to Peer Network
- (b) MAN
- (c) Real Time Communication
- (d) Container Tags

Q5. Expand the following : (4x1=4)

- (a) TCP
- (b) WAN
- (c) URL
- (d) VOID

Q6.

DELHI



DELHI - THE HEART OF INDIA

Delhi being the capital of the nation is a very special city. It is one of the most vibrant and happening cities in the country.

It is known for its :-

Monuments

Food

Markets

(7)

Notes :

- (a) Give the title as shown.
 - (b) Top margin should be half inch, background colour as green.
 - (c) Heading 'Delhi - The Heart of India' should be of Level 2, center, yellow and underlined.
 - (d) Paragraph should be in 'Comic Sans MS' font and red colour.
 - (e) The words 'Monuments', 'Food' and 'Market' should be in blue colour and size 4.
- Q7. Riya wants to setup her own computer training institute. She wants to connect all computers and printers to each other using wires within her institute. (2)
- (a) Which type of networking cable and connectors will she use?
 - (b) Name the type of network would be formed in doing so.

(3)

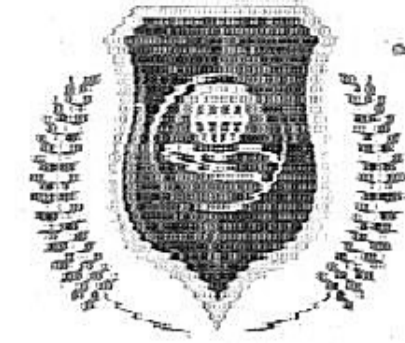

**SACHDEVA
GLOBAL SCHOOL**

Class - VIII	General Knowledge	S.A. I	9-09-16
--------------	-------------------	--------	---------

Name:	M.M : 20	Time : 1 hour
-------	----------	---------------

Q. 1 Fill in the blanks:

(1/2x10=5)

- a) _____ is the Indian state which has the lowest literacy rate.
- b) _____ is the language which is spoken in Odisha.
- c) _____ is the highest court of justice in our country.
- d) Huge masses of ice floating in a sea are called _____.
- e) _____ is an animal which has the longest life span.
- f) _____ is the branch of physics that deals with properties of light.
- g) In computer jargon, GIGO stands for _____.
- h) Malgudi Days is written by _____.
- i) UNICEF has its headquarters at _____.
- j) _____ invented the mobile phone.

Q. 2 Identify the following and write the names:

(1x4=4)

- a) Hindi novelist and short story writer; pioneer of social novel in India; wrote mainly about the life of the peasants and lower middle classes; Godan, Karamabhumi, Seva Sadan are his major novels.

- b) Chief figure behind India's missile programme; contributed substantially to the nuclear tests conducted at Pokhran; honoured by Bharat Ratna in 1997; the President of India during 2002-2007.

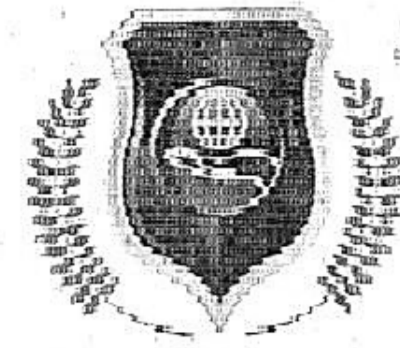

- c) First Indian woman boxer to win a gold medal in the Asian games 2014; a bronze at the London Olympics; only woman to win a medal in each of the six world championships; recipient of Padma Bhushan.
-

- d) One of the agencies of UNO that aims at helping nations to increase their food production.
-

Q. 3 Write true or false:

(1/2x6=3)

- a) Harappa is the important site of Indus Valley Civilization. _____
- b) Equator is the site of zero meridian. _____
- c) The sum and the product of two odd numbers are always odd. _____
- d) Martin Luther King was the first black President of South Africa. _____
- e) Carat is used to measure the weight of precious stones. _____
- f) Asthma is a chest disease in which breathing is very difficult. _____

Q. 4 Solve the following:

(1x3=3)

- a) If MINISTER is written as 72423580 and COUNT is written as 16945, what word is written as 50693803 ?
-

- b) Rearrange the letters of the word EARLY to make two new words?
-

- c) Find the next two terms of the series:

1 3 6 18 36 _____

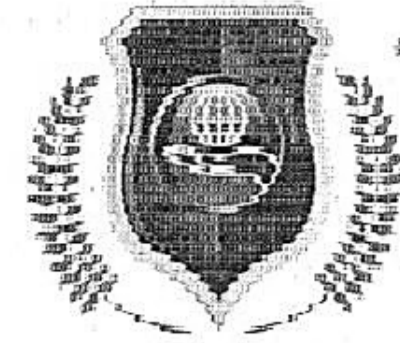

**SACHDEVA
GLOBAL SCHOOL**

CURRENT AFFAIRS

(1x5=5)

a) The first Children Court of South India has been launched in which city?

b) Which country will be the focused country at the 2016 International Film Festival of India (IFFI)?

c) The Bharat Sanchar Nigam Limited (BSNL) has signed MoU with which technology giant to offer telecom and IT solutions?

d) What is the India's rank on the 2016 World Risk Index?

e) Which country will host the 19th South Asian Association for Regional Cooperation (SAARC) summit 2016?
